



# Croma planter

---



Made of aluminum and available in three different sizes, with capacities of 15, 26, and 40 liters. with capacities that adapt to any need. Their round shape adds a contemporary touch, while the legs, which also come with a chrome option, not only maintain the formal coherence of the collection but also elevate the planters, providing a unique visual and facilitating their mobility.

## Dimensions

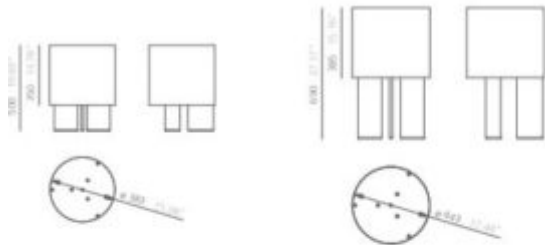

## PLANTER

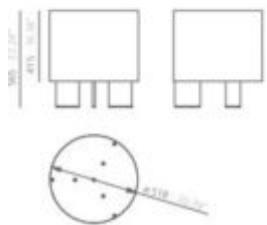

## SPECIFICATIONS



Commercial Furniture · Product Data Sheet

**Arms**

Yes

**Leadtime**

12 weeks +

**Stacking**

No

**Price**

More than 500